

Data Sheet

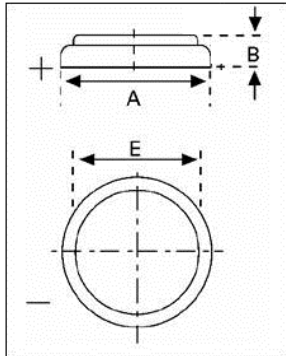

Type Number 6032
Designation IEC CR 2032
System Li-Manganese dioxide / Organic Electrolyte
UL Recognition MH 13654 (N)
Nominal Voltage 3 V
Typical Capacity C 230 mAh
 Load 5.6 kOhm, at 20°C down to 2 V
Weight (approx.) 3 g
Volume 0,95 ccm
Coding..... Date of Manufacturing Month / Year

Temperature Ranges

	min.	max.
Storage	- 55°C	70°C
Discharge	- 20°C	70°C

Dimensions

	min.	max.
Diameter (A)	19,7	20,0
Height (B)	2,9	3,2
Shoulder Diameter (E)	16,0	

Segment Electronic

Main Applications Watch
 Photo
 Electronic

Typical Capacities (at 20°C)

Discharge Type	Load	End Voltage:	2.0 V
Continuous 24h / d, 7d / w Current [µA]:	5600 Ω	Time:	460 h
		Capacity [mAh]:	230
		Energy [mWh]:	645