

**Specifications**

Nominal Voltage		8 V
Capacity (25°C)	20HR(7.00V)	3.2Ah
	10HR(7.00V)	3.0Ah
	1HR(6.40V)	2.08Ah
Dimension	Length	134 ± 1mm (5.28inch)
	Width	36 ± 1mm (1.42inch)
	Height	63 ± 1mm (2.48inch)
	Total Height	69 ± 1mm (2.72inch)
Approx. Weight		0.85kg (1.87lbs) ± 5%
Terminal type		T1
Internal resistance (Fully charged, 25°C)		Approx. 28mΩ
Capacity affected by temperature (20HR)	40°C	102%
	25°C	100%
	0°C	85%
	-15°C	65%
Self-discharge (25°C)	3 month	Remaining Capacity: 91%
	6 month	Remaining Capacity: 82%
	12 month	Remaining Capacity: 65%
Nominal operating temperature		25°C ± 3°C (77°F ± 5°F)
Operating temperature range	Discharge	-15°C ~ 50°C (5°F ~ 122°F)
	Charge	-10°C ~ 50°C (14°F ~ 122°F)
	Storage	-20°C ~ 50°C (-4°F ~ 122°F)
Float charging voltage(25°C)		9.00 to 9.20V Temperature compensation: -12mV/°C
Cyclic charging voltage(25°C)		9.70 to 9.90V Temperature compensation: -20mV/°C
Maximum charging current		0.96A
Terminal material		Copper
Maximum discharge current		48A(5 sec.)
Designed floating life(20°C)		10years

- ◆ Absorbent glass mat technology;
- ◆ Recognized by UL & CE;
- ◆ ABS container.

**Constant Current Discharge Characteristics (A, 25°C)**

F.V/TIME	5min	10min	15min	30min	60min	2h	3h	4h	5h	10h	20h
6.40V	12.2	7.68	6.08	3.39	2.08	1.14	0.82	0.65	0.55	0.30	0.16
6.60V	11.8	7.45	5.93	3.32	2.05	1.13	0.81	0.65	0.55	0.30	0.16
6.80V	11.3	7.14	5.72	3.22	2.00	1.12	0.81	0.64	0.55	0.30	0.16
7.00V	10.8	6.8	5.52	3.14	1.96	1.10	0.80	0.64	0.54	0.30	0.16
7.20V	10.2	6.45	5.23	3.03	1.90	1.08	0.78	0.62	0.53	0.29	0.15

**Constant Power Discharge Characteristics (Watt, 25°C)**

F.V/TIME	5min	10min	15min	30min	60min	2h	3h	4h	5h	10h	20h
6.40V	90.5	57.8	46.2	25.9	16.1	8.87	6.46	5.18	4.42	2.42	1.30
6.60V	87.8	56.0	45.1	25.4	15.8	8.81	6.42	5.15	4.39	2.41	1.29
6.80V	84.1	53.7	43.4	24.6	15.4	8.74	6.38	5.12	4.36	2.40	1.29
7.00V	80.5	51.4	42.0	24.0	15.1	8.60	6.34	5.08	4.33	2.38	1.28
7.20V	76.0	48.5	39.7	23.1	14.6	8.39	6.15	4.93	4.20	2.33	1.25

Note: The above characteristics data can be obtained within three charge/discharge cycles.

**Dimensions**

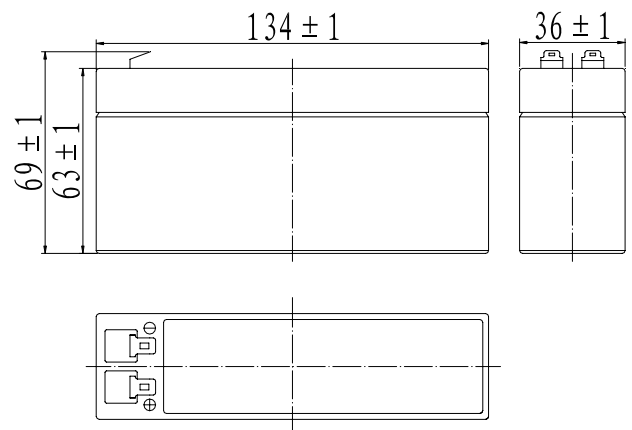

**Terminal**

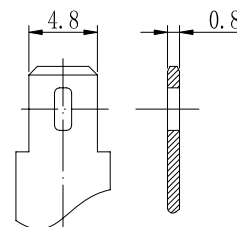

Terminal T1

**Discharge Characteristics(25°C)**

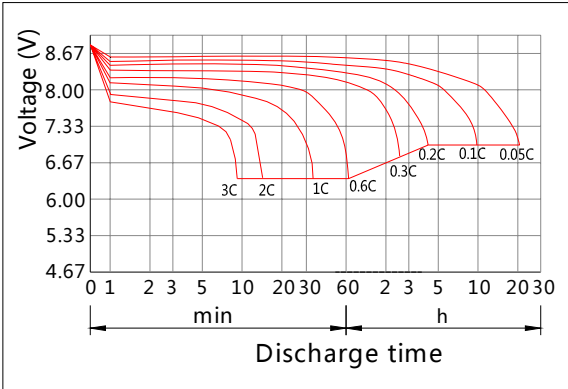

**Charging Characteristics(25°C)**

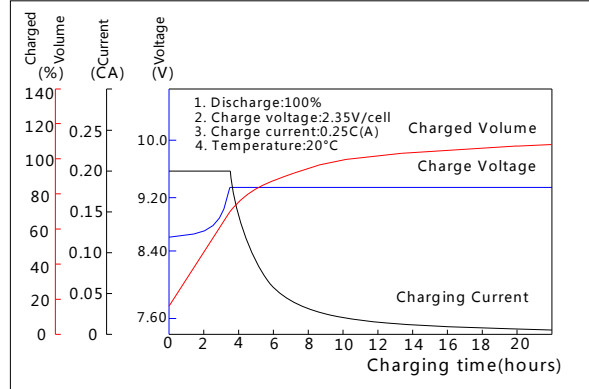

**Effect of Temperature on Capacity**

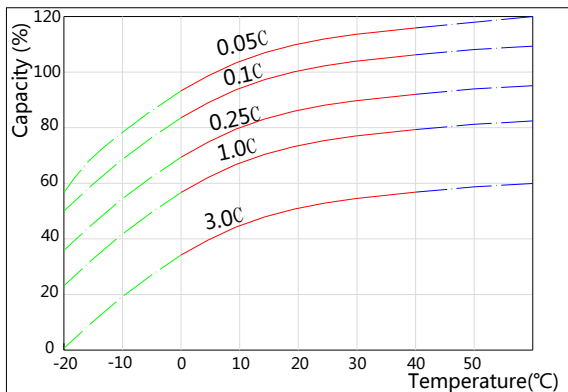

**Self-discharge Characteristics**

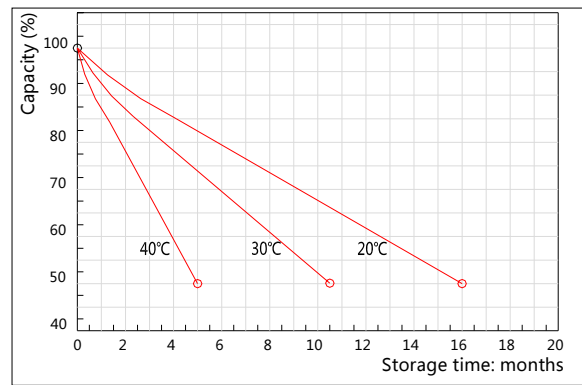

**The Relationship for Open Circuit Voltage and Residual Capacity (25°C)**

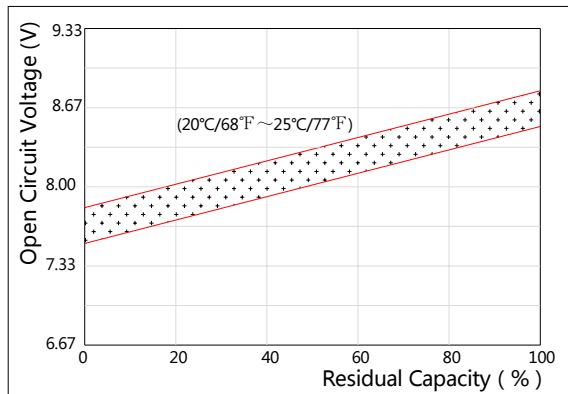

**The Relationship for Charging Voltage and Temperature**

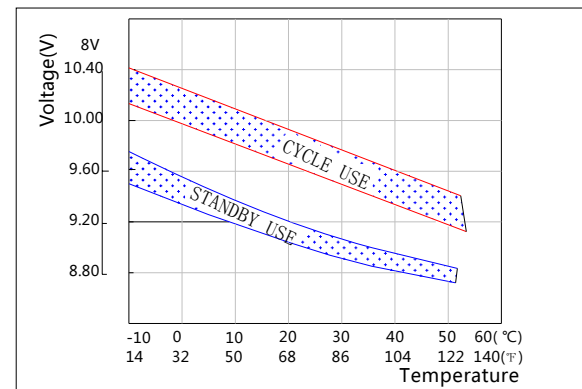

**Floating Life on Temperature**

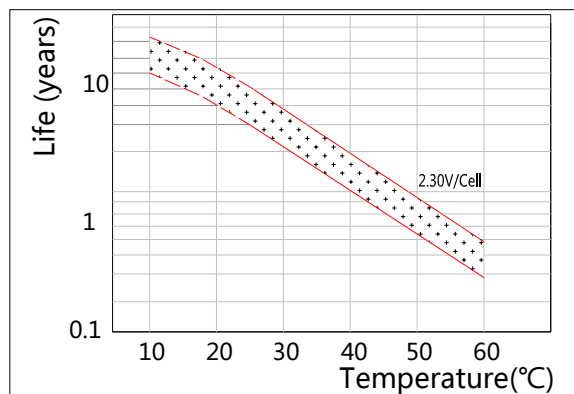

**Cycle Life on D.O.D(25°C)**

